

Thermocouple Coiled Cords



THERMOCOUPLE COILED CORDS				
Part #	Calibration	Retracted length	Extended length	Molded Plug Fitted
CCP-K	K	11"	6' 6"	Yes
CCP-J	J	11"	6' 6"	Yes
CCP-T	T	11"	6' 6"	Yes
CCP-K	K	24"	14'	Yes
CCP-J	J	24"	14'	Yes
CCP-T	T	24"	14'	Yes
CC-RTD	RTD, 4-wire	11"	6' 6"	No
Other configurations available to order - consult sales office				

- 24 AWG stranded conductors
- All type K cords now with high accuracy Special Limits wire: $\pm 2^{\circ}\text{F}$
- Polyurethane outer insulation offers fast and strong snap back to retain original shape
- Teflon inner insulation gives cord greater strength and higher operating temperature than the standard PVC offered by competitors
Note: some cords have polyurethane inner insulation. Consult with sales office if this is important to your application
- Special design of the high quality molded plug locks the wires in place and can withstand pull up to 20 lb
- Many options & other calibrations available to special order

Thermocouple Probe Handles



PROBE HANDLES		
Item	Part #	Description
1	HBB-18	Adaptor for 1/8" probe
1	HBB-36	Adaptor for 3/16" probe
1	HBB-14	Adaptor for 1/4" probe
2, 3 & 4	HBB-K	Handle Kit

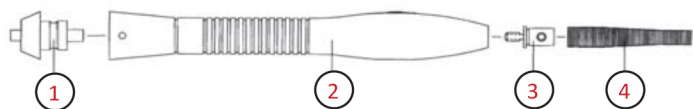

Item	Description	Material
1	Adaptor for 1/8", 3/16" & 1/4" probe	Ni Plated Brass
2	Handle	Bakelite
3	Spring Connector	Ni Plated Brass
4	Strain Relief Spring	SS304

- Purchase Handle Kits (# HBB-K) and adaptors (HBB-18/35/14) separately
- Adaptors for metric & other sizes available upon request
- Upgrade your hand-held probes with these high quality handles